

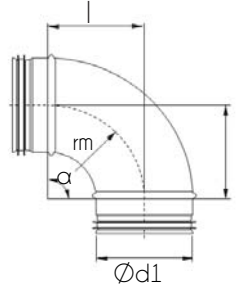

## Bogen gepresst / Coudes emboutis



$$r \approx 1 \cdot d1$$

Ød mm	l mm	90°		60°		45°		30°		15°	
		CHF	mm	CHF	mm	CHF	mm	CHF	mm	CHF	
250	250	50.00	144	47.00	250	50.00	144	47.00	33	32.00	
280	280	53.00	162	47.00	280	53.00	162	47.00	37	33.00	
300	300	60.00	173	50.00	300	60.00	173	50.00	39	37.00	
315	315	74.00	182	59.00	315	74.00	182	59.00	41	41.00	
355	355	93.00	205	65.00	355	93.00	205	65.00	47	47.00	
400	400	93.00	231	79.00	400	93.00	231	79.00	53	57.00	
450	450	115.00	260	95.00	450	115.00	260	95.00	59	73.00	
500	500	130.00	289	110.00	500	130.00	289	110.00	66	77.00	
560	560	170.00	323	130.00	560	170.00	323	130.00	74	85.00	
600	600	240.00	346	163.00	600	240.00	346	163.00	79	110.00	
630	730	260.00	364	186.00	730	260.00	364	186.00	83	126.00	
710	710	430.00	410	315.00	710	430.00	410	315.00	93	185.00	
800	800	560.00	462	390.00	800	560.00	462	390.00	105	190.00	
900	900	670.00	520	470.00	900	670.00	520	470.00	118	255.00	
1000	1000	780.00	577	620.00	1000	780.00	577	620.00	132	348.00	